

Front Footrest Construction

BENE31J19506011

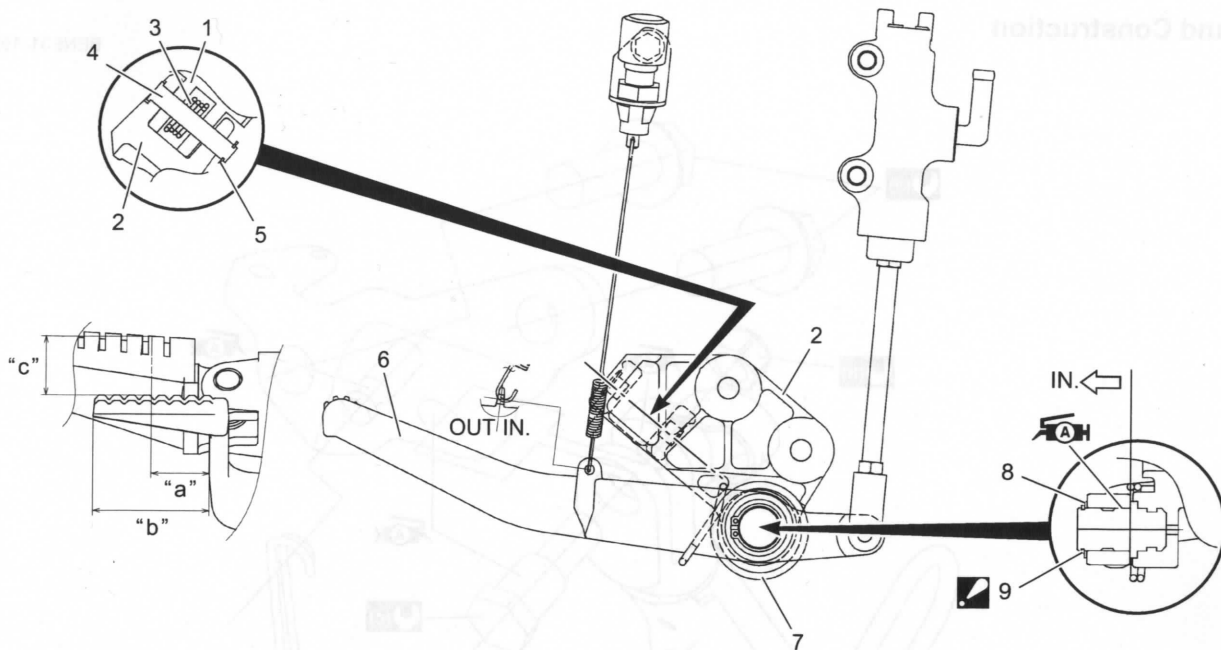

IE31J1950001-03

1. Front footrest	5. Front footrest E-ring	9. Brake pedal clip : Assemble the clip with sharp edge side in.	: Apply grease to sliding surface.
2. Front footrest bracket	6. Rear brake pedal	"a": 24 mm (0.9 in)	
3. Front footrest spring	7. Rear brake pedal spring	"b": 48.9 mm (1.9 in)	
4. Front footrest pin	8. Brake pedal washer	"c": 20 - 30 mm (0.8 - 1.2 in)	

Front Footrest Removal and Installation

Refer to "Front Footrest Construction" (Page 9E-2).

BENE31J19506015

Pillion Footrest Construction

BENE31J19506012

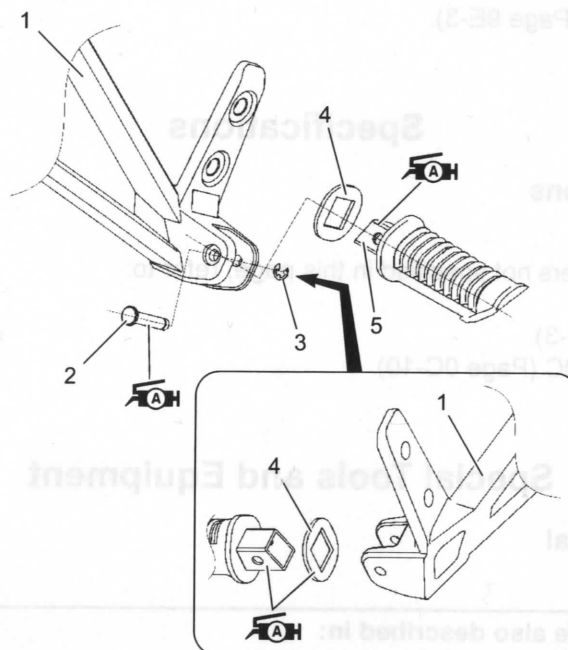

IE31J1950002-02

1. Pillion footrest bracket	3. Pillion footrest E-ring	5. Pillion footrest bar
2. Pillion footrest pin	4. Footrest rubber washer	: Apply grease to sliding surface.